

CTL DECISION SHEET

Standard(s)- IEC 60335-1:2001	Sub clause(s): 20.2	DSH 623
Subject: Test probe to check the protection for moving parts	Key words: - Test probe - Circular stop face	Approved by the 45th CTL Plenary Meeting 2008

Question:

Which test probe is correct to check the protection for moving parts according to sub-clause 20.2?

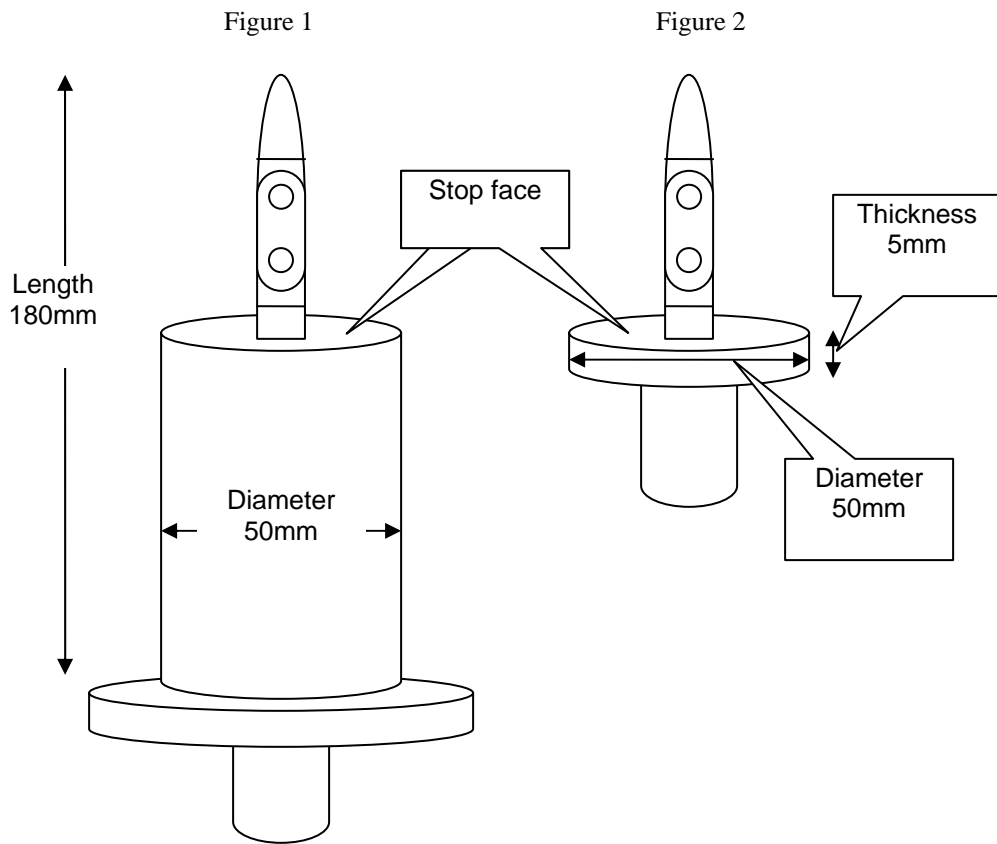

Rationale:

The clarification of the length of the stop face is necessary, because, it influences the test result in the following case.

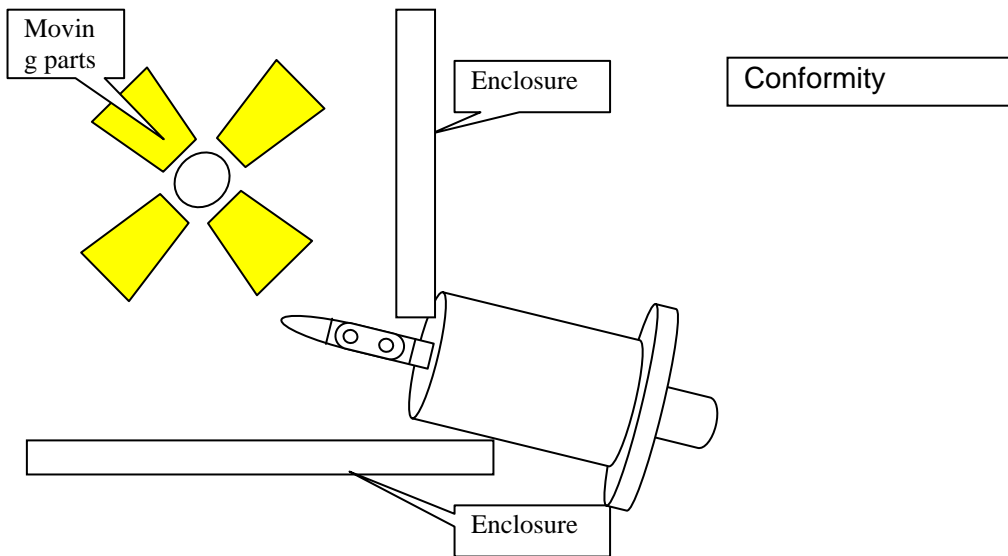
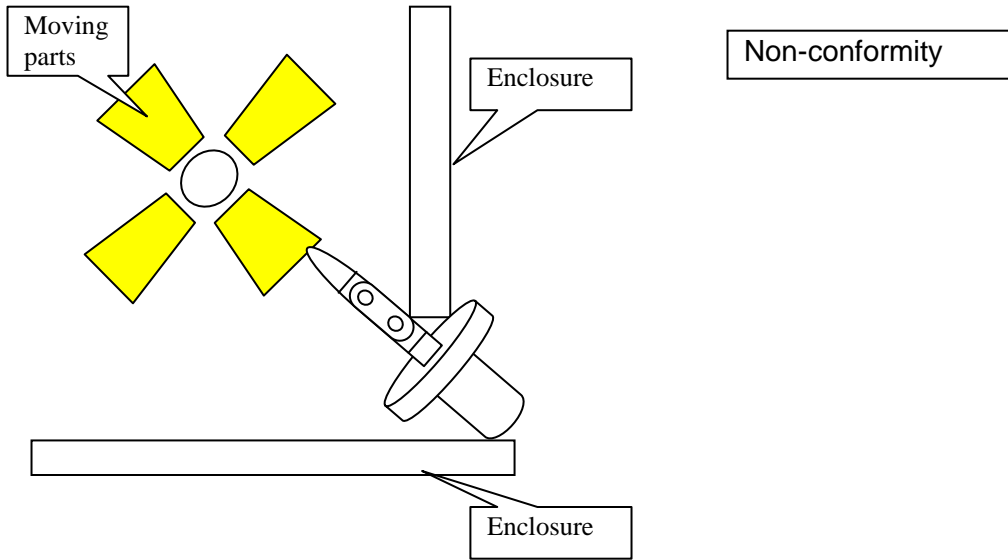

Decision:

Figure 1 is used for the test according to sub-clause 20.2 based on modified test probe B of 61032(1997) +Corrigendum1 (2003).